

## 测试报告

编号 : SZIN2005005355PS\_CN

日期 : 2020-05-15

页码 : 1 of 8

扫码查看在线报告



SZIN2005005355PS

客户名称: 深圳市遨游通讯设备有限公司  
客户地址: 深圳市龙华区福城街道桔塘社区新塘村 8 号源创园陆号 A9 栋三楼 302

样品名称 : AORO\_A9  
产品规格 : 168.2\*82\*15MM  
材质牌号 : 塑料

以上信息及样品由客户提供及确认, SGS 不承担证实客户提供信息的准确性、适当性和(或)完整性的责任。

\*\*\*\*\*

SGS 参考号 : GZIN2005019599MR\_CN  
收样日期 : 2020-05-08  
测试开始时间 : 2020-05-08  
测试结束时间 : 2020-05-15  
测试结果 : 请见下页 (除另有特别说明外, 此报告结果仅对测试样品负责)

通标标准技术服务有限公司深圳分公司  
检测中心  
授权签名

郑伟雄

授权签字人



SGS-CSTC 通标标准技术服务有限公司  
Shenzhen Branch Testing Center - Materials Laboratory

Unless otherwise agreed in writing, this document is issued by the Company subject to its General Conditions of Service printed overleaf, available on request or accessible at <http://www.sgs.com/en/Terms-and-Conditions.aspx> and, for electronic format documents, subject to Terms and Conditions for Electronic Documents at <http://www.sgs.com/en/Terms-and-Conditions/Terms-e-Document.aspx>. Attention is drawn to the limitation of liability, indemnification and jurisdiction issues defined therein. Any holder of this document is advised that information contained hereon reflects the Company's findings at the time of its intervention only and within the limits of Client's instructions, if any. The Company's sole responsibility is to its Client and this document does not exonerate parties to a transaction from exercising all their rights and obligations under the transaction documents. This document cannot be reproduced except in full, without prior written approval of the Company. Any unauthorized alteration, forgery or falsification of the content or appearance of this document is unlawful and offenders may be prosecuted to the fullest extent of the law. Unless otherwise stated the results shown in this test report refer only to the sample(s) tested and such sample(s) are retained for 30 days only.

Attention: To check the authenticity of testing / inspection report & certificate, please contact us at telephone: (86-755) 8307 1443, or email: CN.Doccheck@sgs.com

SGS Bldg, No. 4, Jianghao Industrial Park, No. 430, Jihua Road, Bantian, Longgang District, Shenzhen, China 518129 t (86-755) 25328282 f (86-755) 83197625 www.sgs.com.cn  
中国·深圳·龙岗区坂田吉华路430号江灏工业园4栋SGS大楼 邮编: 518129 t (86-755) 25328282 f (86-755) 83197625 e sgs.china@sgs.com

## 测试报告

编号 : SZIN2005005355PS\_CN

日期 : 2020-05-15

页码 : 2 of 8

结果总结:

序号	测试项目	测试方法	结果	结论
1	IP6X	参照 IEC 60529:1989/AMD2:2013/COR1:2019 和客户要求	详见结果	合格
2	IPX8	IEC 60529:1989/AMD2:2013/COR1:2019	详见结果	合格

备注: 合格: 达到要求  
不合格: 未达到要求  
/: 不下判定

原样照片:



Unless otherwise agreed in writing, this document is issued by the Company subject to its General Conditions of Service printed overleaf, available on request or accessible at <http://www.sgs.com/en/Terms-and-Conditions.aspx> and, for electronic format documents, subject to Terms and Conditions for Electronic Documents at <http://www.sgs.com/en/Terms-and-Conditions/Terms-e-Documents.aspx>. Attention is drawn to the limitation of liability, indemnification and jurisdiction issues defined therein. Any holder of this document is advised that information contained hereon reflects the Company's findings at the time of its intervention only and within the limits of Client's instructions, if any. The Company's sole responsibility is to its Client and this document does not exonerate parties to a transaction from exercising all their rights and obligations under the transaction documents. This document cannot be reproduced except in full, without prior written approval of the Company. Any unauthorized alteration, forgery or falsification of the content or appearance of this document is unlawful and offenders may be prosecuted to the fullest extent of the law. Unless otherwise stated the results shown in this test report refer only to the sample(s) tested and such sample(s) are retained for 30 days only.

Attention: To check the authenticity of testing / inspection report & certificate, please contact us at telephone: (86-755) 8307 1443, or email: CN.Doccheck@sgs.com

SGS-CSTC 检验检测专用章  
Shenzhen Branch Inspection & Testing Services

SGS Bldg, No. 4, Jianghao Industrial Park, No. 430, Jihua Road, Bentian, Longgang District, Shenzhen, China 518129 t (86-755) 25328282 f (86-755) 83197625 www.sgs.com.cn  
中国·深圳·龙岗区坂田吉华路430号江灏工业园4栋SGS大楼 邮编: 518129 t (86-755) 25328282 f (86-755) 83197625 e sgs.china@sgs.com

## 测试报告

编号 : SZIN2005005355PS\_CN

日期 : 2020-05-15

页码 : 3 of 8

1.测试项目: IP6X

样品描述: 手机

测试方法: 参照 IEC 60529:1989/AMD2:2013/COR1:2019 和客户要求

测试条件:

测试粉尘: 滑石粉

粉尘浓度: 2kg/m3 粉尘并在试验中保持悬浮

不抽负压

测试周期: 8 小时

实验室环境条件: 15°C~35°C, 25%RH~75%RH

测试结果:

样品	测试结果	客户要求	结论
#1	1.无可见进尘 2.样品可以开机; 3.充电、显示、触摸屏、音乐、 WIFI/GPS/BT 功能有效。	1.无可见进尘 2.样品可以开机; 3.充电、显示、触摸屏、音乐、 WIFI/GPS/BT 功能有效。	合格

测试照片:

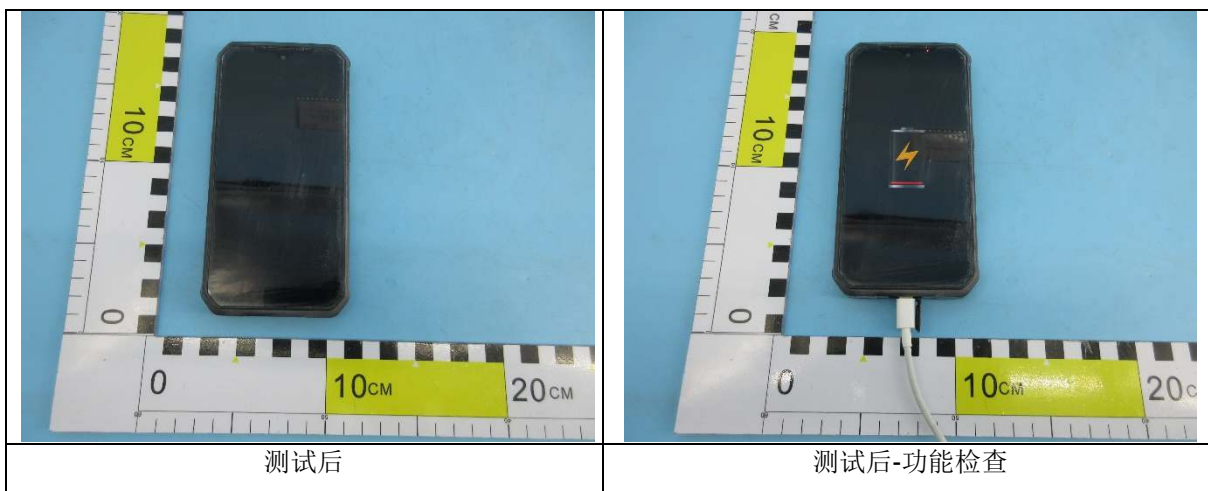

Unless otherwise agreed in writing, this document is issued by the Company subject to its General Conditions of Service printed overleaf, available on request or accessible at <http://www.sgs.com/en/Terms-and-Conditions.aspx> and, for electronic format documents, subject to Terms and Conditions for Electronic Documents at <http://www.sgs.com/en/Terms-and-Conditions/Terms-e-Documents.aspx>. Attention is drawn to the limitation of liability, indemnification and jurisdiction issues defined therein. Any holder of this document is advised that information contained hereon reflects the Company's findings at the time of its intervention only and within the limits of Client's instructions, if any. The Company's sole responsibility is to its Client and this document does not exonerate parties to a transaction from exercising all their rights and obligations under the transaction documents. This document cannot be reproduced except in full, without prior written approval of the Company. Any unauthorized alteration, forgery or falsification of the content or appearance of this document is unlawful and offenders may be prosecuted to the fullest extent of the law. Unless otherwise stated the results shown in this test report refer only to the sample(s) tested and such sample(s) are retained for 30 days only.  
Attention: To check the authenticity of testing / inspection report & certificate, please contact us at telephone: (86-755) 8307 1443, or email: CN.Doccheck@sgs.com

SGS Bldg, No. 4, Jianghao Industrial Park, No. 430, Jihua Road, Bantian, Longgang District, Shenzhen, China 518129 t (86-755) 25328282 f (86-755) 83197625 www.sgsgroup.com.cn  
中国·深圳·龙岗区坂田吉华路430号江灏工业园4栋SGS大楼 邮编: 518129 t (86-755) 25328282 f (86-755) 83197625 e sgs.china@sgs.com

## 测试报告

编号 : SZIN2005005355PS\_CN

日期 : 2020-05-15

页码 : 4 of 8



测试后-功能检查



测试后-局部



Unless otherwise agreed in writing, this document is issued by the Company subject to its General Conditions of Service printed overleaf, available on request or accessible at <http://www.sgs.com/en/Terms-and-Conditions.aspx> and, for electronic format documents, subject to Terms and Conditions for Electronic Documents at <http://www.sgs.com/en/Terms-and-Conditions/Terms-e-Documents.aspx>. Attention is drawn to the limitation of liability, indemnification and jurisdiction issues defined therein. Any holder of this document is advised that information contained hereon reflects the Company's findings at the time of its intervention only and within the limits of Client's instructions, if any. The Company's sole responsibility is to its Client and this document does not exonerate parties to a transaction from exercising all their rights and obligations under the transaction documents. This document cannot be reproduced except in full, without prior written approval of the Company. Any unauthorized alteration, forgery or falsification of the content or appearance of this document is unlawful and offenders may be prosecuted to the fullest extent of the law. Unless otherwise stated the results shown in this test report refer only to the sample(s) tested and such sample(s) are retained for 30 days only.

Attention: To check the authenticity of testing / inspection report & certificate, please contact us at telephone: (86-755) 8307 1443, or email: CN.Doccheck@sgs.com  
 SGS Bldg, No. 4, Jianghao Industrial Park, No. 430, Jilua Road, Bentian, Longgang District, Shenzhen, China 518129 t (86-755) 25328282 f (86-755) 83197625 www.sgs.com.cn  
 中国·深圳·龙岗区坂田吉华路430号江灏工业园4栋SGS大楼 邮编: 518129 t (86-755) 25328282 f (86-755) 83197625 e sgs.china@sgs.com

## 测试报告

编号 : SZIN2005005355PS\_CN

日期 : 2020-05-15

页码 : 5 of 8

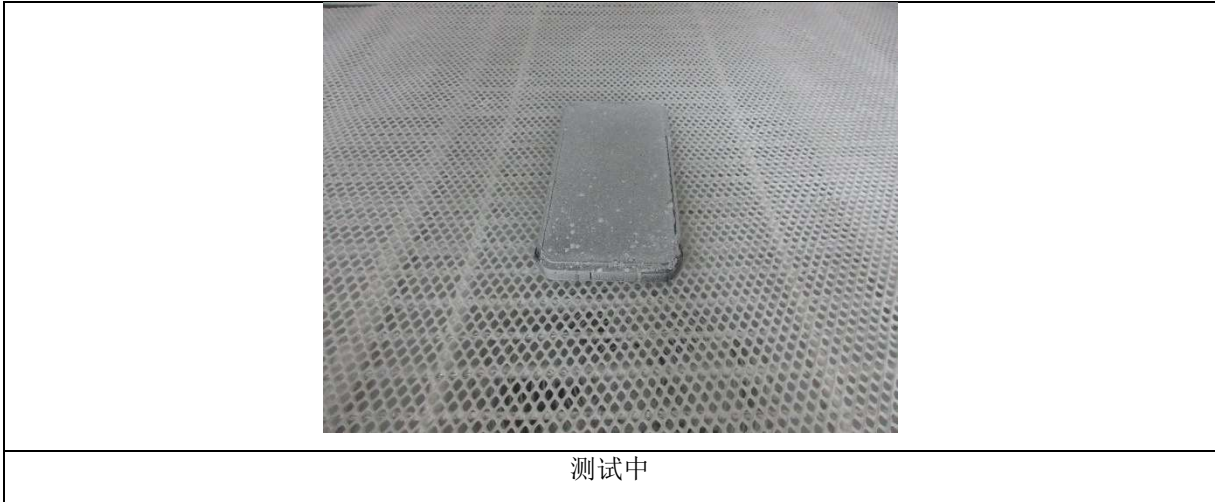

### 设备信息:

设备	型号	设备编号	校准日期	下次校准日期
砂尘试验箱	MS-SC-010	GZMR-RL-E119	2020-04-27	2021-04-26



Unless otherwise agreed in writing, this document is issued by the Company subject to its General Conditions of Service printed overleaf, available on request or accessible at <http://www.sgs.com/en/Terms-and-Conditions.aspx> and, for electronic format documents, subject to Terms and Conditions for Electronic Documents at <http://www.sgs.com/en/Terms-and-Conditions/Terms-e-Documents.aspx>. Attention is drawn to the limitation of liability, indemnification and jurisdiction issues defined therein. Any holder of this document is advised that information contained hereon reflects the Company's findings at the time of its intervention only and within the limits of Client's instructions, if any. The Company's sole responsibility is to its Client and this document does not exonerate parties to a transaction from exercising all their rights and obligations under the transaction documents. This document cannot be reproduced except in full, without prior written approval of the Company. Any unauthorized alteration, forgery or falsification of the content or appearance of this document is unlawful and offenders may be prosecuted to the fullest extent of the law. Unless otherwise stated the results shown in this test report refer only to the sample(s) tested and such sample(s) are retained for 30 days only.

Attention: To check the authenticity of testing / inspection report & certificate, please contact us at telephone: (86-755) 8307 1443, or email: CN.Doccheck@sgs.com

SGS-CSTC 深圳技术服务有限公司  
Shenzhen Branch Testing Center - Materials Laboratory

SGS Bldg, No. 4, Jianghao Industrial Park, No. 430, Jilua Road, Bentian, Longgang District, Shenzhen, China 518129 t (86-755) 25328282 f (86-755) 83197625 www.sgsgroup.com.cn  
中国·深圳·龙岗区坂田吉华路430号江灏工业园4栋SGS大楼 邮编: 518129 t (86-755) 25328282 f (86-755) 83197625 e sgs.china@sgs.com

## 测试报告

编号 : SZIN2005005355PS\_CN

日期 : 2020-05-15

页码 : 6 of 8

2.测试项目: IPX8

样品描述: 手机

测试方法: IEC 60529:1989/AMD2:2013/COR1:2019

测试条件:

水深: 1.2 m

测试时间: 40 min

实验室环境条件: 15°C~35°C, 25%RH ~ 75%RH

测试结果:

样品	测试结果	客户要求	结论
#2	1.无可见进尘 2.样品可以开关机; 3.充电、显示、触摸屏、音乐、WIFI/GPS/BT 功能有效。	1.无可见进尘 2.样品可以开关机; 3.充电、显示、触摸屏、音乐、WIFI/GPS/BT 功能有效。	合格

测试照片:

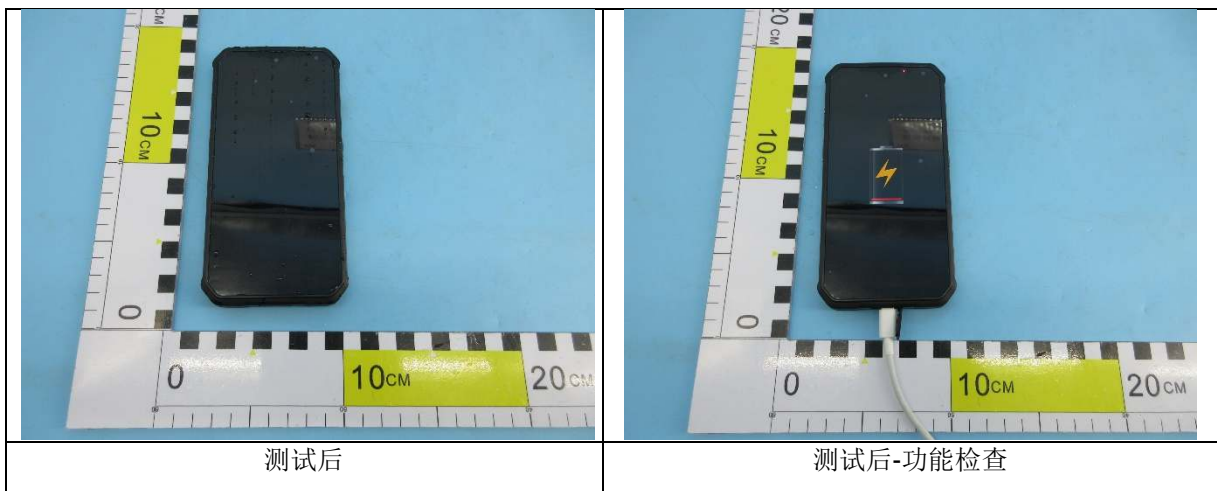

Unless otherwise agreed in writing, this document is issued by the Company subject to its General Conditions of Service printed overleaf, available on request or accessible at <http://www.sgs.com/en/Terms-and-Conditions.aspx> and, for electronic format documents, subject to Terms and Conditions for Electronic Documents at <http://www.sgs.com/en/Terms-and-Conditions/Terms-e-Documents.aspx>. Attention is drawn to the limitation of liability, indemnification and jurisdiction issues defined therein. Any holder of this document is advised that information contained hereon reflects the Company's findings at the time of its intervention only and within the limits of Client's instructions, if any. The Company's sole responsibility is to its Client and this document does not exonerate parties to a transaction from exercising all their rights and obligations under the transaction documents. This document cannot be reproduced except in full, without prior written approval of the Company. Any unauthorized alteration, forgery or falsification of the content or appearance of this document is unlawful and offenders may be prosecuted to the fullest extent of the law. Unless otherwise stated the results shown in this test report refer only to the sample(s) tested and such sample(s) are retained for 30 days only.

Attention: To check the authenticity of testing / inspection report & certificate, please contact us at telephone: (86-755) 8307 1443, or email: CN.Doccheck@sgs.com  
 SGS Bldg, No. 4, Jianghao Industrial Park, No. 430, Jihua Road, Bantian, Longgang District, Shenzhen, China 518129 t (86-755) 25328282 f (86-755) 83197625 www.sgsgroup.com.cn  
 中国·深圳·龙岗区坂田吉华路430号江灏工业园4栋SGS大楼 邮编: 518129 t (86-755) 25328282 f (86-755) 83197625 e sgs.china@sgs.com

## 测试报告

编号 : SZIN2005005355PS\_CN

日期 : 2020-05-15

页码 : 7 of 8

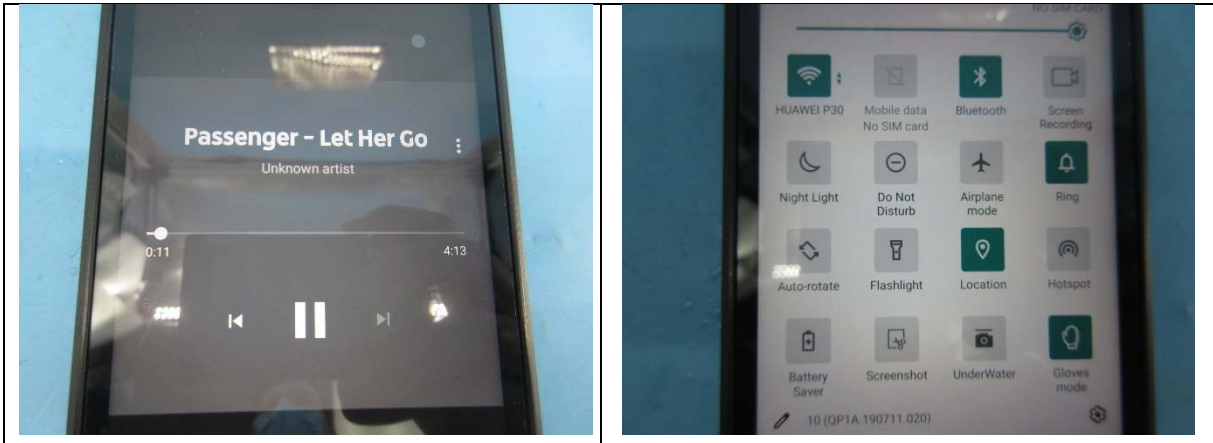

测试后-功能检查



测试后-局部

## 测试报告

编号 : SZIN2005005355PS\_CN

日期 : 2020-05-15

页码 : 8 of 8

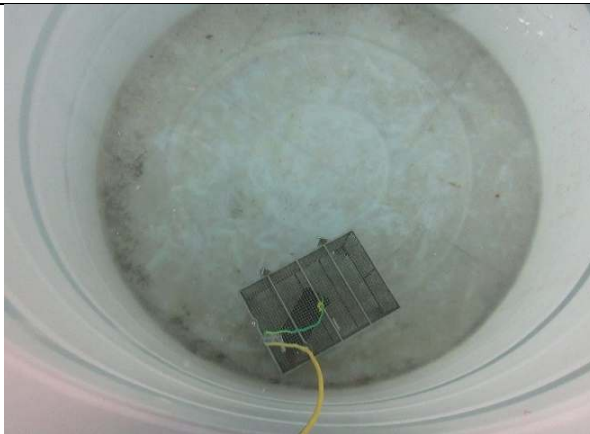

测试中

### 附录信息:

1. 以上项目是在通标标准技术服务有限公司广州分公司进行。
2. 该检测报告为由 SGS（深圳）发布的原检测报告编号：SZIN2005005355PS 的中文译本，如中英文有歧义，概以英文为准。

\*\*\*\*\* 报告结束\*\*\*\*\*



Unless otherwise agreed in writing, this document is issued by the Company subject to its General Conditions of Service printed overleaf, available on request or accessible at <http://www.sgs.com/en/Terms-and-Conditions.aspx> and, for electronic format documents, subject to Terms and Conditions for Electronic Documents at <http://www.sgs.com/en/Terms-and-Conditions/Terms-e-Documents.aspx>. Attention is drawn to the limitation of liability, indemnification and jurisdiction issues defined therein. Any holder of this document is advised that information contained hereon reflects the Company's findings at the time of its intervention only and within the limits of Client's instructions, if any. The Company's sole responsibility is to its Client and this document does not exonerate parties to a transaction from exercising all their rights and obligations under the transaction documents. This document cannot be reproduced except in full, without prior written approval of the Company. Any unauthorized alteration, forgery or falsification of the content or appearance of this document is unlawful and offenders may be prosecuted to the fullest extent of the law. Unless otherwise stated the results shown in this test report refer only to the sample(s) tested and such sample(s) are retained for 30 days only.  
Attention: To check the authenticity of testing / inspection report & certificate, please contact us at telephone: (86-755) 8307 1443, or email: CN.Doccheck@sgs.com

SGS Bldg, No. 4, Jianghao Industrial Park, No. 430, Jilua Road, Bantian, Longgang District, Shenzhen, China 518129 t (86-755) 25328282 f (86-755) 83197625 www.sgs.com.cn  
中国·深圳·龙岗区坂田吉华路430号江灏工业园4栋SGS大楼 邮编: 518129 t (86-755) 25328282 f (86-755) 83197625 e sgs.china@sgs.com